

SITE PLAN 800 GAY STREET

LEGEND	
SITE BOUNDARY LINES	
ADJACENT PROPERTY LINES	
EXISTING CONTOURS	
EXISTING TREELINE	
EXISTING SOIL TYPE	
SWM DEVICE	
PROPOSED CONTOUR	
PROPOSED L.O.D.	
PROPOSED CONCRETE	
PROPOSED GRAVEL PARKING AREA	
ZONING LINE	

E 164°33'53" E
N 446,450

E 164°33'53" E
N 446,450



**MI ZONING
MR ZONING**

ROBERT W & JUDY A BRITTON
801 GAY STREET
DENTON, MD 21629
TMAP. 103 BLK. 17 P. 575
TA #03-019047
DEED: 1019 / 01
ZONING: MI

MICHAEL SHANNON WINTERS
SHAWN MCKEE
803 GAY STREET
DENTON, MD 21629
TMAP. 103 BLK. 17 P. 575
TA #03-041956
DEED: 1497 / 93
ZONING: MI

GAY STREET
(EX. VARIABLE WIDTH
R/W SHA PLAT #26204)

ANGELYN B ESTWICK
722 GAY STREET
DENTON, MD 21629
TMAP. 103 BLK. 17 P. 548
TA #03-001842
DEED: 516 / 388
ZONING: MR

CHRISTINA MCCOY
804 GAY STREET
DENTON, MD 21629
TMAP. 103 BLK. 23 P. 537
TA #03-016315
DEED: 1270 / 430
ZONING: MR

JASON PUMPHREY
KRISTINA EVANS
11 N EIGHTH STREET
DENTON, MD 21629
TMAP. 103 BLK. 17 P. 561
TA #03-010058
DEED: 811 / 264
ZONING: MR

FIRST WESLEYAN CHURCH
OF DENTON INC/
412 N EIGHTH STREET
DENTON, MD 21629
TMAP. 103 BLK. 23 P. 539
TA #03-025454
DEED: 227 / 66
ZONING: MR

8TH STREET
(EX. 40' PUBLIC ROW)

PR. RAINGARDEN
(M-7) 217 SF.
(SWMIP #3)

PR. RAINGARDEN
(M-7) 262 SF.
(SWMIP #3)

PARCEL 538
14,485 SF / 0.33 AC

PR. DUPLEX
(ON SLAB)
UNITS 5-6
FF=47.87

PR. RAINGARDEN
(M-7) 302 SF.
(SWMIP #1)

LOD S69° 51' 59" E 94.90'

LOD N19° 29' 46" E 154.05'

PLAN VIEW
SCALE: 1"=20'

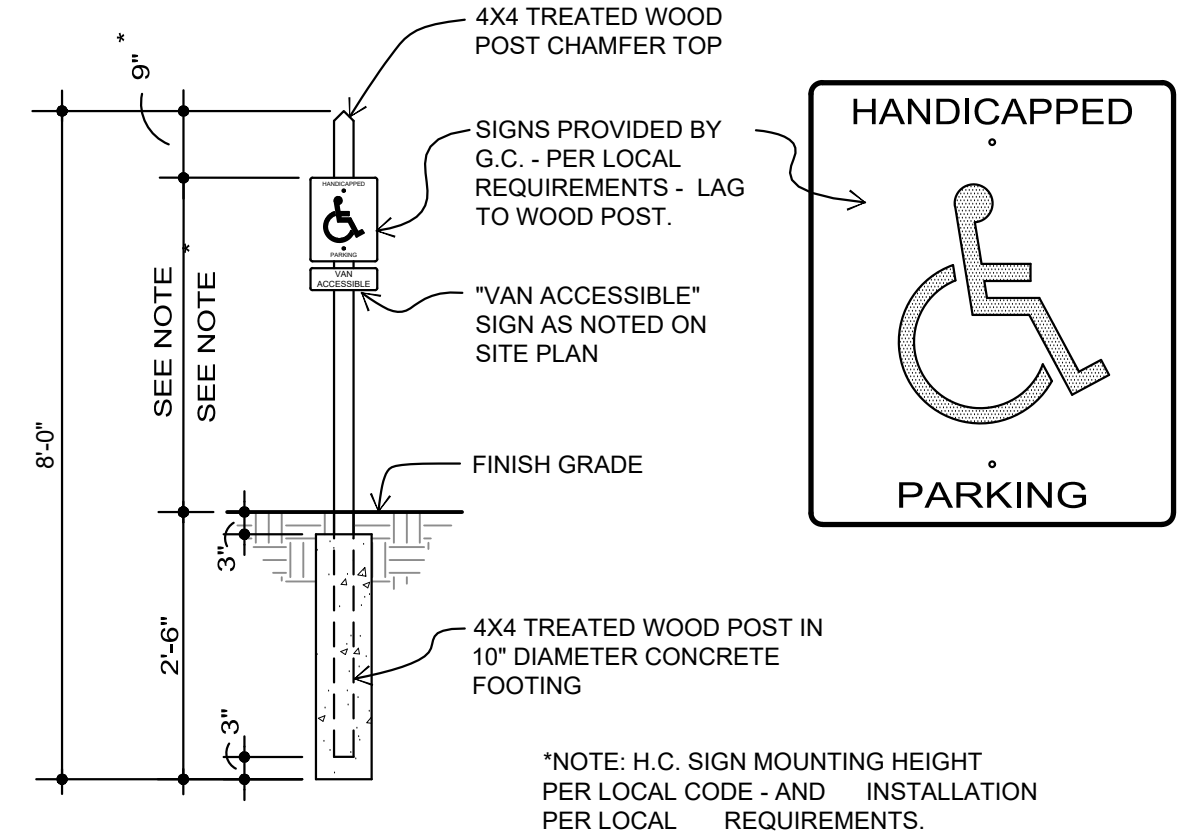

HANDICAP SIGN DETAIL
NOT TO SCALE

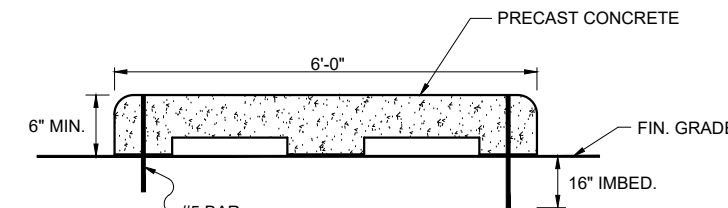
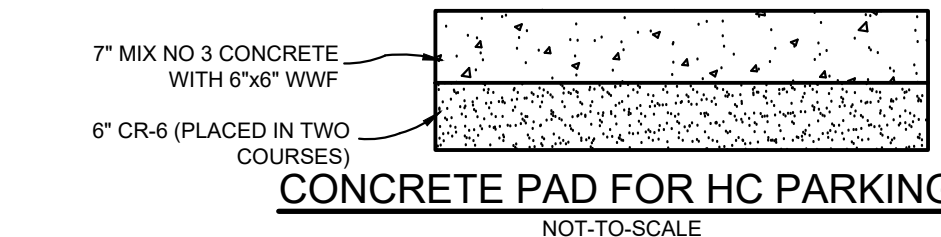
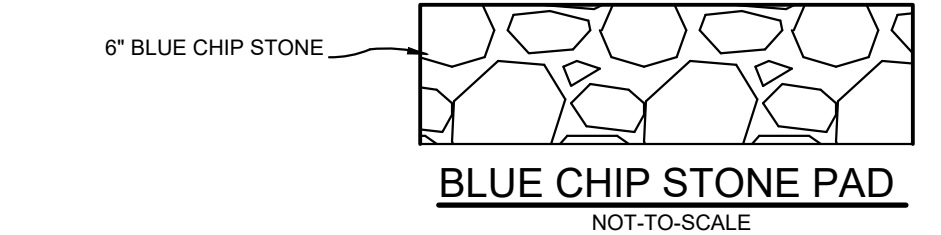

WHEELSTOP DETAIL
NOT-TO-SCALE

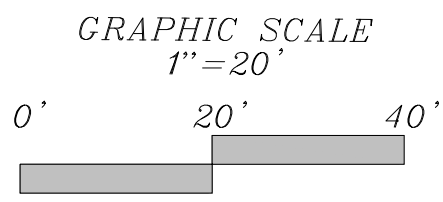

E 164°33'53" E
N 446,325

OWNER:
800 GAY STREET LLC.
163 RYAN ROAD
PASADENA, MD 21122
443-618-0059
ARBUILDERSINC79@GMAIL.COM

DEVELOPER:
AR BUILDERS, INC
163 RYAN ROAD
PASADENA, MD 21122
443-618-0059
ARBUILDERSINC79@GMAIL.COM

DESIGNED	CMB	05/26
DRAWN	ZAW	05/26
CHECKED	CMB	05/26
APPROVED	STA	05/26

REVISIONS		
DATE	BY	DESCRIPTION

DFI ENGINEERS-SURVEYORS-PLANNERS
CONSTRUCTION MANAGERS
1127 BENFIELD BLVD, SUITE K
MILLERSVILLE, MD 21108
WWW.DFIENGINEERING.COM
443-308-2100 FAX 443-308-2108

DocuSigned by
Michael Shannon Winters
Professional Engineer
5/7/2026

SITE PLAN
800 GAY STREET
ZONING: MR / IRD OVERLAY ZONE
TAX MAP 103 BLOCK 17 PARCEL 538
SCALE: AS SHOWN DATE: MAY, 2026
ZIP CODE: 21629
3RD ELECTION DISTRICT CAROLINE COUNTY, MARYLAND

SHEET
2
OF
8